



SAN FRANCISCO PRIDE



JUNE 27 & 28, 2026

**ALL AGENCY PLANNING
MEETING**

WEDNESDAY, MAY 27, 2026



General Information

ONSITE COMMAND PHONE: +1 415-379-0049

Available Saturday June 28th and Sunday, June 29th 10:00 am - 7:00 pm

EVENT HOTLINE (For General Public): +1 415-294-1844

Available June 22 to June 26: Mon – Fri, 10:00 AM and 6:00 PM Available 24 hours June 27-28. Or email: info@sfpride.org

Persons Responsible for Operations during the event

- Kyle Meyers, Executive Producer, Silverback 773.457.0653 kyle@gosilverback.com
- Michael Bush, Technical Director, Silverback 415.370.2731 michael@gosilverback.com
- Suzanne Ford, Executive Director, SF Pride 415.827.5463 suzzane.ford@sfpride.org
- Chris Robert, Deputy Director, SF Pride, 415.233.6990 chris.robert@sfpride.org
- Joshua Smith Board President, SF Pride, joshua.smith@sfpride.org

Security, Safety and Medical

- Dr Anthony Luke - UCSF, 415.238.7721, anthony.luke@ucsf.edu
- Peter Tapia - Special Medical Aid, 415.722.8876, specialmed1@yahoo.com
- Christopher Colwell - UCSF, 303.246.5323, christopher.colwell@ucsf.edu
- Shaw Amirghassemkhany, Shaw Management Group, 415.720.8741, shaw@iknowshaw.com

2026 Updates

- Reduced footprint - Northern boundary Golden Gate Ave
- **Increased staffing and volunteer support** provided by Turn Out
- **Beverage Program format** benefitting LGBTQ+ Community Groups with consultation and oversight provided by local concessionaire, Rye on the Road and support from Turn Out
- **Larger grandstand viewing area** at UN Plaza for Parade Sunday
- **Returning Security Management Team** - Shaw Management
- **Returning Medical Team** - UCSF + Special Med + AMR - Dr Christopher Colwell - Chief of Emergency Medicine at SF General



Street Closures

				
SF PRIDE 2026 Temporary Street Closures				
Location	Day	Time Closed	Tow-Away Enforcement	Day/Time Reopened
Grove between Polk and Larkin	Tuesday, June 23	9:00 AM	8:00 AM	Tuesday, June 30 / 9:00 AM
Fulton between Larkin and Hyde	Thursday, June 25	7:00 AM		Tuesday, June 30 / 9:00 AM
Dr Carleton B. Goodlett between McAllister and Grove	Thursday, June 25	7:00 PM	6:00 PM	Monday, June 29 / 6:00 AM
Larkin between McAllister and Market	Thursday, June 25	7:00 PM	6:00 PM	Monday, June 29 / 6:00 AM
Grove between Van Ness and Hyde	Friday, June 26	9:00 AM	8:00 AM	Monday, June 29 / 6:00 AM
Lech Walesa between Polk and Van Ness	Friday, June 26	8:00 PM	7:00 PM	Monday, June 29 / 6:00 AM
Polk between Grove and Hayes	Friday, June 26	8:00 PM	7:00 PM	Monday, June 29 / 6:00 AM
McAllister between Van Ness and Leavenworth	Friday, June 26	8:00 PM	7:00 PM	Monday, June 29 / 6:00 AM
Hyde between McAllister and Grove	Friday, June 26	8:00 PM	7:00 PM	Monday, June 29 / 6:00 AM
Continuum Alley (all)	Friday, June 26	8:00 PM	7:00 PM	Monday, June 29 / 6:00 AM
Hyde between Golden Gate and McAllister	Friday, June 26	8:00 PM	7:00 PM	Monday, June 29 / 6:00 AM
Larkin between Golden Gate and McAllister	Friday, June 26	8:00 PM	7:00 PM	Monday, June 29 / 6:00 AM
Polk between Golden Gate and McAllister	Friday, June 26	8:00 PM	7:00 PM	Monday, June 29 / 6:00 AM
Redwood between Van Ness and Polk	Friday, June 26	8:00 PM	7:00 PM	Monday, June 29 / 6:00 AM
Leavenworth between Market and McAllister	Sunday, June 28	12:01 AM	11:00 PM (Sat)	Sunday, June 28 / 5:00 PM
Market between 8th and 9th	Sunday, June 28	6:00 AM	5:00 AM	Sunday, June 28 / 5:00 PM
Sutter between Sansom and Market	Sunday, June 28	12:01 AM	11:00 PM (Sat)	Sunday, June 28 / 5:00 PM
Sansome (nb) between Sutter and Bush	Sunday, June 28	12:01 AM	11:00 PM (Sat)	Sunday, June 28 / 5:00 PM

Taxi Stands:

1. On Turk Street, south east corner of Polk
2. On Turk Street north east corner of Larkin
3. On Van Ness, eastside between Grove and McAllister, in front of City Hall



No Stopping

SF PRIDE FESTIVAL - No Stopping Summary

6/23/2026 6/30/2026

Sign Variations:	START	END	Print	Blue Zone PRINT
A	Tues 6/23/26 7 AM	Tues 6/30/26 9 AM	26	3
B	Thu 6/25/26 6 PM	Mon 6/29/26 6 AM	65	8
C	Thu 6/25/26 8 AM	Mon 6/29/26 6 PM	35	3
D	Fri 6/26/26 6 AM	Mon 6/29/26 6 AM	37	5
E	Fri 6/26/26 6 PM	Mon 6/29/26 8 AM	171	10
F	Sat 6/27/26 11 PM	Sun 6/28/26 8 PM	38	2
G	Tues 6/23/26 6 AM	Tues 6/30/26 7 AM	6	-
H	Sat 6/27/26 11 PM	Sun 6/28/26 5 PM	14	-
			392	31

City Streets:

VAR	Street	From	To	SIDE	Blocks	<<<POSTING>>>	<<<POSTING>>>	Qty	PRINT	BLUE ZONES	WHOLE BLOCK	Meters	Posting Notes	Production Notes	Type	Post By	Post Day
A	GROVE	LARKIN	POLK	BOTH	52-99	No Parking from	No Parking until	24	26	2	YES	446-00490 to -00980	EVERY OTHER METER POST		M	Mon 6/22 7 AM	Sun 6/21
B	DR CARLTON B GOODLETT	GROVE	MCALLISTER	BOTH	0-99	Thu 6/25/26 6 PM	Mon 6/29/26 6 AM	33	35	2	YES	612-03020 to -03540	EVERY 40' ON DEL + BLUE	FOR DELIVERIES & CITY HALL	M	Wed 6/24 6 PM	Tues 6/23
B	VAN NESS	GROVE	MCALLISTER	EAST	300-498	Thu 6/25/26 6 PM	Mon 6/29/26 6 AM	10	11	1	YES	701-03020 to -04160	EVERY OTHER METER + BLUE		M	Wed 6/24 6 PM	Tues 6/23
B	GROVE	HYDE	LARKIN	BOTH	0-55	Thu 6/25/26 6 PM	Mon 6/29/26 6 AM	18	19	2	YES	446-00070 to -00400	EVERY OTHER METER + BLUE & WHITE		M	Wed 6/24 6 PM	Tues 6/23
C	LARKIN	HAYES	MCALLISTER	BOTH	0-299	Thu 6/25/26 8 AM	Mon 6/29/26 6 PM	33	35	3	YES	542-00030 to -02210	EVERY 40' ON DEL + BLUE & WHITE		M	Wed 6/24 8 AM	Tues 6/23
D	GROVE	POLK	VAN NESS	BOTH	100-199	Fri 6/26/26 6 AM	Mon 6/29/26 6 AM	16	17	1	YES	446-01040 to -01270	EVERY OTHER METER + BLUE & WHITE		M	Thu 6/25 6 AM	###
D	POLK	HAYES	GROVE	BOTH	100-199	Fri 6/26/26 6 AM	Mon 6/29/26 6 AM	10	11	2	YES	612-01030 to -01230	EVERY OTHER METER + BLUE		M	Thu 6/25 6 AM	###
D	DR TOM WADDELL	POLK	VAN NESS	BOTH	0-99	Fri 6/26/26 6 AM	Mon 6/29/26 6 AM	8	9	0	YES	547-00020 to -00420	EVERY OTHER METER		M	Thu 6/25 6 AM	###
E	HYDE	GROVE	MCALLISTER	BOTH	0-59	Fri 6/26/26 6 PM	Mon 6/29/26 6 AM	14	15	0	YES	472-00010 to -00450	EVERY OTHER METER + WHITE		M	Thu 6/25 6 PM	###
E	VAN NESS	MCALLISTER	REDWOOD	EAST	510-524	Fri 6/26/26 6 PM	Mon 6/29/26 6 AM	2	3	0	YES	Unknown	METERS + YELLOW		M	Thu 6/25 6 PM	###
E	MCALLISTER	LEAVENWORTH-VAN NESS	BOTH	100-499	Fri 6/26/26 6 PM	Mon 6/29/26 6 AM	58	61	2	YES	563-00510 to -04340	EVERY OTHER METER (40') + BLUE & WHITE		M	Thu 6/25 6 PM	###	
E	HYDE	MCALLISTER	GOLDEN GATE	BOTH	50-99	Fri 6/26/26 6 PM	Mon 6/29/26 6 AM	25	27	1	YES	472-00060 to -00920	EVERY OTHER METER + BLUE & WHITE		M	Thu 6/25 6 PM	###
E	LARKIN	MCALLISTER	GOLDEN GATE	BOTH	300-399	Fri 6/26/26 6 PM	Mon 6/29/26 6 AM	28	30	1	YES	542-03060 to -03300	EVERY OTHER METER (40') + BLUE & WHITE		M	Thu 6/25 6 PM	###
E	POLK	MCALLISTER	GOLDEN GATE	BOTH	400-499	Fri 6/26/26 6 PM	Mon 6/29/26 6 AM	28	30	2	YES	612-05010 to -04250	EVERY OTHER METER (40') + BLUE & WHITE		M	Thu 6/25 6 PM	###
E	REDWOOD	POLK	VAN NESS	BOTH	100-199	Fri 6/26/26 6 PM	Mon 6/29/26 6 AM	4	5	0	YES	640-01150 to -01430	EVERY SPOT		M	Thu 6/25 6 PM	###
F	LEAVENWORTH	MCALLISTER	GOLDEN GATE	BOTH	52-99	Sat 6/27/26 11 PM	Sun 6/28/26 8 PM	23	25	1	YES	546-00510 to -00800	EVERY OTHER METER + BLUE & WHITE		M	Fri 6/26 11 PM	Thu 6/25
F	MCALLISTER	MARKET	LEAVENWORTH	BOTH	0-99	Sat 6/27/26 11 PM	Sun 6/28/26 8 PM	12	13	0	YES	543-00160 to -00420	EVERY OTHER METER (40') + WHITE		M	Fri 6/26 11 PM	Thu 6/25
G	1663 MISSION ST	400R		SOUTH		Tues 6/23/26 6 AM	Tues 6/30/26 7 AM	5	6	0	NO	N/A	EVERY 40' - (NOT BLUE ZONE)	OFFICE LOADING	R	Mon 6/22 7 AM	Sun 6/21
H	SUTTER	MARKET	SANSOME	BOTH		Sat 6/27/26 11 PM	Sun 6/28/26 5 PM	4	5	0	YES	N/A	BROADCAST		M	Fri 6/26 11 PM	Thu 6/25
H	SANSOME	SUTTER	BUSH	BOTH	0-59	Sat 6/27/26 11 PM	Sun 6/28/26 5 PM	8	9	0	YES	Unknown	Motorcycle Parking Spots (NB Only)	BROADCAST	M	Fri 6/26 11 PM	Thu 6/25

SF PRIDE 2026 CELEBRATION MAP SFMTA NO PARKING TOW AWAY ZONE SIGN AREAS

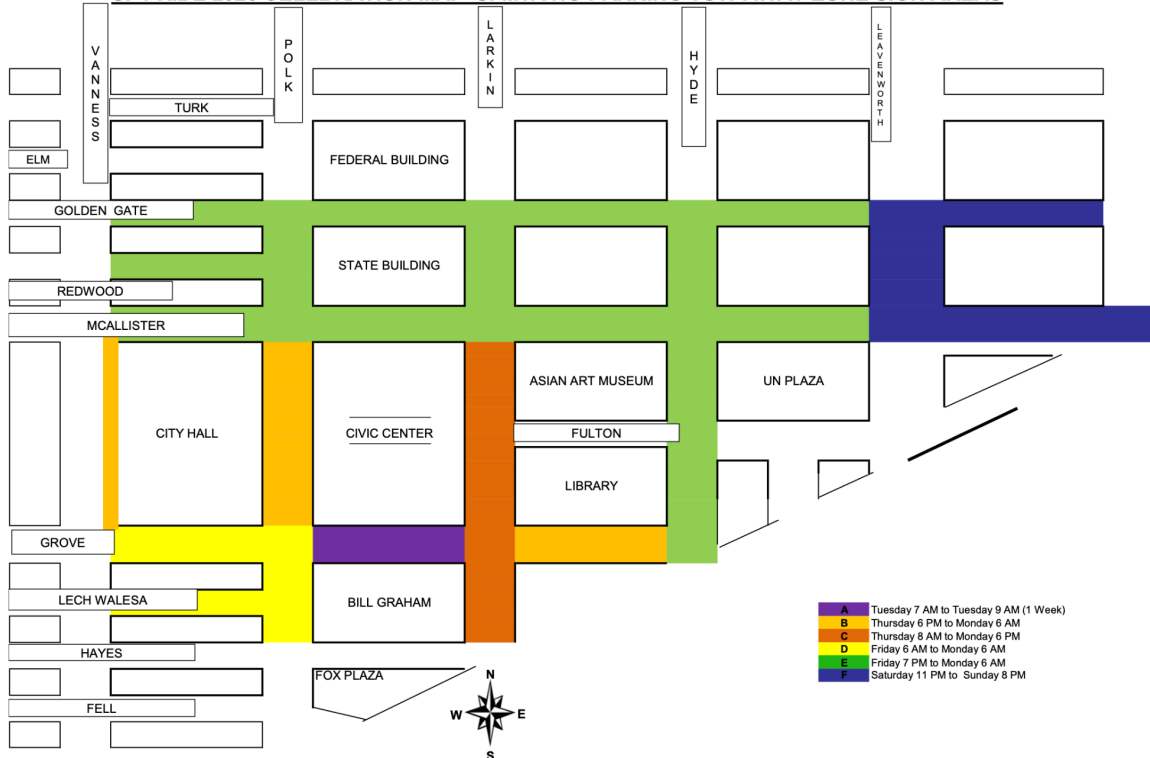

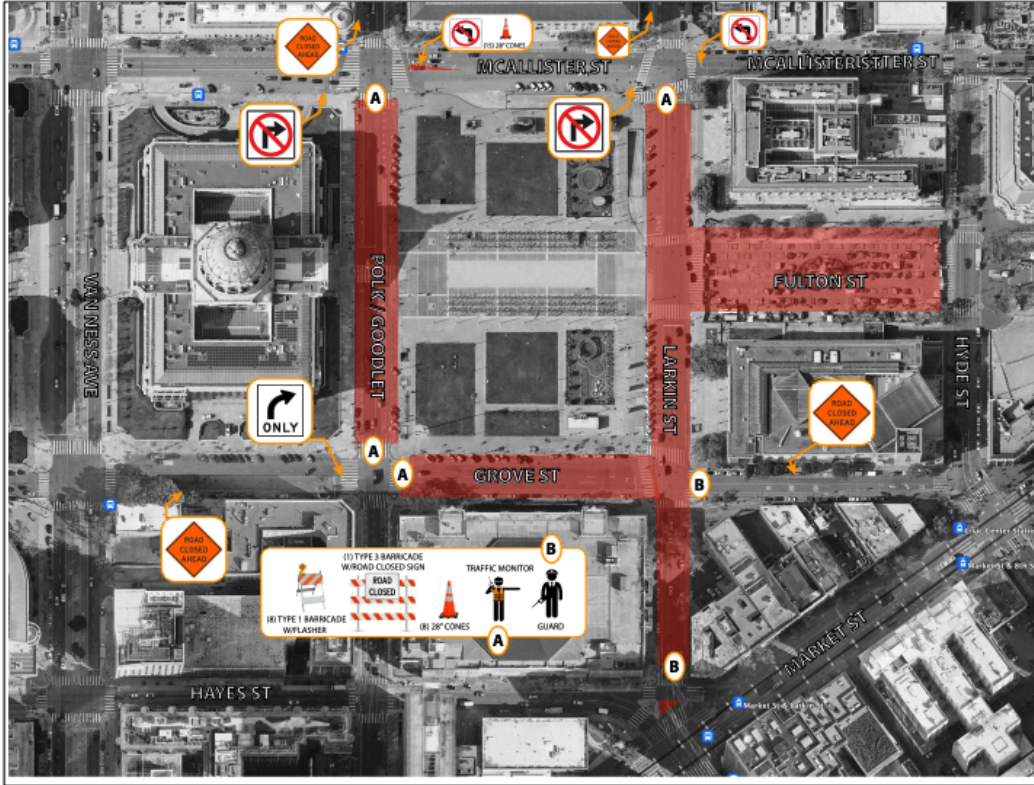

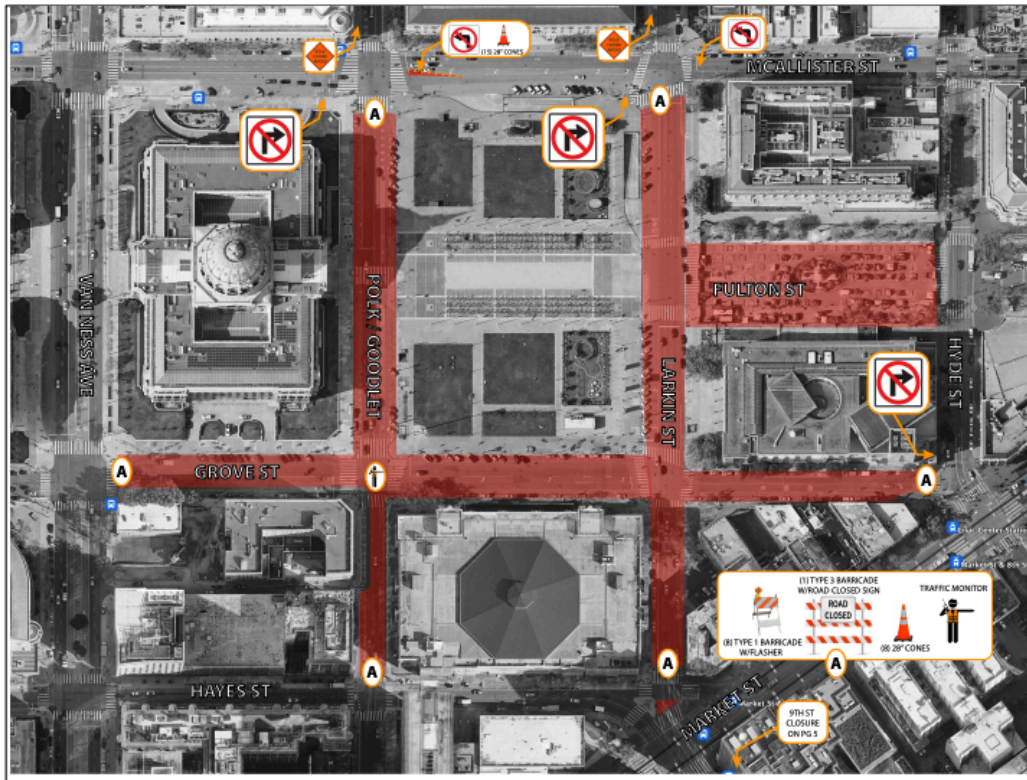

TRAFFIC CONTROL PLAN	
SF PRIDE 2026 EVENT DATE: JUNE 28TH	
PRODUCED BY SILVERBACK PACIFIC	
CLOSURE THURSDAY, JUNE 25TH @ 7:00 PM	
POLK/GOODLET BETWEEN MCALLISTER & GROVE	
LARKIN ST BETWEEN MARKET & MCALLISTER	
EQUIPMENT & PERSONNEL	
(2) PCMS BOARDS	
(6) TYPE 3 BARRICADES W/ROAD CLOSED SIGNS	
(48) TYPE 1 BARRICADES W/FLASHERS	
(48) 28" CONES	
(4) FABRIC DIRECTIONAL SIGNS	
(4) TRAFFIC MONITORS	
(2) GUARDS	
SCALE 1" = 150'	
DATE 04-09-2026	
DRAFTED BY ERIK SHEPNER	
SEED	PAGE 3

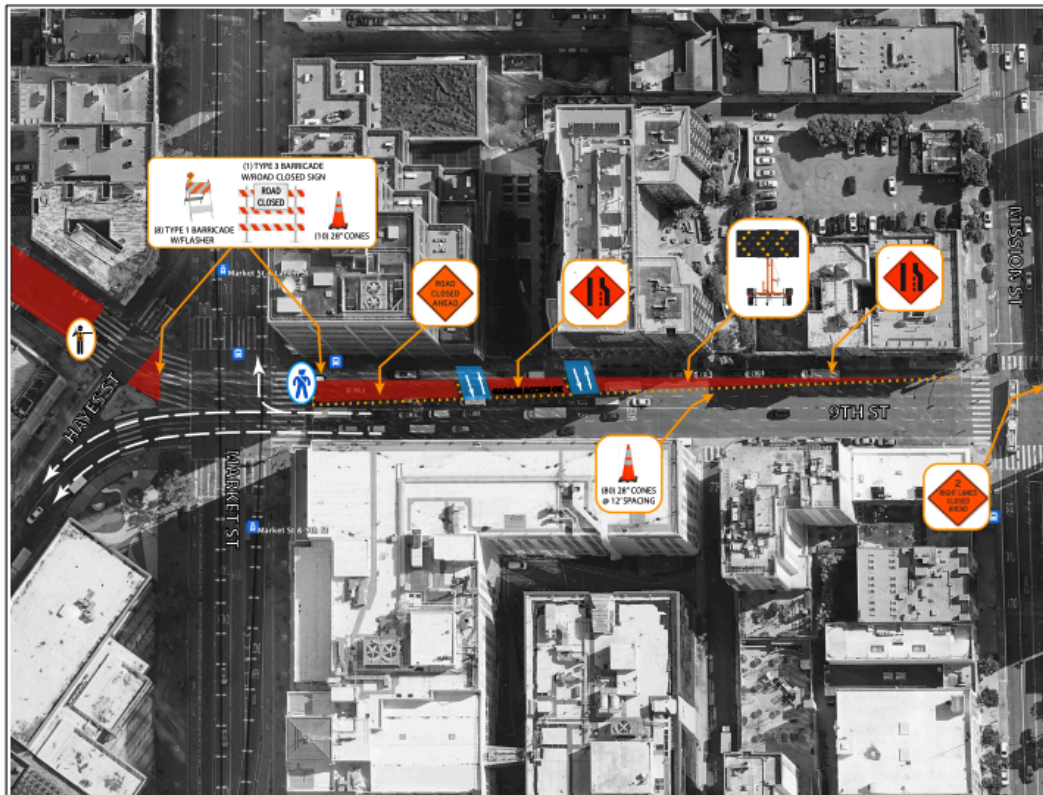

TRAFFIC CONTROL PLAN	
CIVIC CENTER CONCERT EVENT DATE: JUNE 6TH	
PRODUCED BY ANOTHER PLANET ENTERTAINMENT 1915 4TH ST, BERKELEY, CA 94710	
CLOSURES FRIDAY, JUNE 26TH @ 9:00 AM	
GROVE BETWEEN VAN NESS & HYDE	
EQUIPMENT & PERSONNEL	
(2) PCMS BOARDS	
(6) TYPE 3 BARRICADES W/ROAD CLOSED SIGNS	
(54) TYPE 1 BARRICADES W/FLASHERS	
(100) 28" CONES	
(7) FABRIC DIRECTIONAL SIGNS	
(9) TRAFFIC MONITORS	
SCALE 1" = 150'	
DATE 04-09-2026	
DRAFTED BY ERIK SHEPNER	
SEED	PAGE 4



TRAFFIC CONTROL PLAN	
SF PRIDE 2026 EVENT DATE: JUNE 28TH	
PRODUCED BY SILVERBACK PACIFIC 	
CLOSURE THURSDAY, JUNE 25TH @ 7:00 PM	
9TH ST NORTHBOUND TO MARKET	
EQUIPMENT & PERSONNEL	
(1) ARROW BOARD	
(2) TYPE 3 BARRICADES W/ROAD CLOSED SIGNS	
(16) TYPE 1 BARRICADES W/FLASHERS	
(100) 28" CONES	
(4) FABRIC DIRECTIONAL SIGNS	
(1) TRAFFIC MONITOR	
(1) PARKING ENFORCEMENT OFFICER	
SCALE 1" = 150'	
DATE 04-09-2026	
DRAFTED BY ERIK SHEPNER	PAGE 5
SEED 	



Replacement Blue Zones SF Pride 2026

#	Location	Meter #
1	Fell at Van Ness SE Corner	Stall 39
2	Van Ness at Hayes SW Corner	Stall 21
3	Van Ness at Grove SW Corner	Stall 19
4	Grove at Van Ness NW Corner	446-02060
5	McAllister at Van Ness SW Corner	563-05050
6	McAllister at Van Ness NW Corner	563-05080
7	Van Ness at Golden Gate NE Corner	Stall 4
8	Van Ness at Elm NE Corner	Stall 20
9	Van Ness at Turk SW Corner	686-07030
10	Turk at Polk SW driveway Corner	686-06030
11	Larkin at Turk NE Corner	686-04060
12	Turk at Hyde SW Corner	686-04070
13	Turk at Leavenworth NW Corner	686-03120
14	Leavenworth at Turk NE Corner	686-02460
15	Golden Gate at Leavenworth NE Corner	442-01460
16	Golden Gate at Leavenworth SE Corner	Pole in front of 187 Golden Gate



Dykes on Bikes Motorcycle Parking

Leavenworth between McAllister and Turk and Golden Gate between Leavenworth and Jones

Temporary Dykes on Bikes No Parking/Street Closure

Location	Day/Time Closed	Day/Time Reopened
Leavenworth between McAllister and Turk both curb lanes	Sunday, June 28 12:01 AM	Sunday June 28 8:00 PM
Golden Gate between Leavenworth and Jones both curb lanes	Sunday, June 28 12:01 AM	Sunday June 28 8:00 PM

Production Command Center

The Production Command Center will be located on Grove Street between Larkin and Hyde

Lost Children

Found children will be placed in our Childcare area inside Bill Graham. Pride staff will immediately notify Operations Dispatch that a child is found or that a parent/guardian is looking for their child. Children not reunited with their parents/guardians after 7PM each day will be brought to SFPD Command.

Information Booth

The information booth will be located in Fulton Plaza. The information booth will be staffed by SF Pride ambassadors. The Booth will also feature an ASL interpreter and a representative from our accessibility team.



2026 STAGES AND VENUES

COMMUNITY STAGES & VENUES	DAY	LOCATION
MAIN STAGE (AAPA / MAIN STAGE SHOW)	SAT / SUN	CIVIC CENTER PLAZA
SOUL OF PRIDE STAGE	SAT & SUN	GROVE AT VAN NESS
PEOPLES MARCH STAGE	SAT	McALLISTER AT VAN NESS
LATIN STAGE	SUN	McALLISTER AT VAN NESS
INDIGIQUEER 2S STAGE	SAT	LARKIN AT GOLDEN GATE
HIP HOP HOORAY	SUN	LARKIN AT GOLDEN GATE
CHEER SAN FRANCISCO	SAT & SUN	FULTON PLAZA
SUNDANCE - COUNTRY	SAT & SUN	MERCY HOUSING LOT
ROOT OF PRIDE	SAT & SUN	McALLISTER AT LEAVENWORTH



**SAN FRANCISCO
PRIDE**



SAFETY & SECURITY



Open Gate Systems will be utilized at all entrances to the Celebration Site

Allied Universal (formally Unified Command) will be installing eighteen (18) HD PTZ Cameras throughout the Celebration Site

SF Pride Celebration Command will be located on the 3rd Floor of BGCA (Grove Hallway)

SF PRIDE CELEBRATION AT CIVIC CENTER PLAZA BAG POLICY AND LIST OF PROHIBITED ITEMS

Security will allow bags that are: Totally clear plastic vinyl or PV and do not exceed 12" x 6" x 12. (Search for "clear stadium approved bags" but double check measurements!)

- Small clutch bags, which cannot exceed 4.5" x 6.5" in size with or without a handle.

Using festival and event best practices, travel light, stay hydrated, and enjoy the day.

The following items are not permitted:

Weapons, regardless of permit

Umbrellas

Cans, thermoses and glass bottles

Any water bottle sealed or not. Empty plastic water bottles allowed.

Outside beverages and beverage containers

Outside food products and containers

Chairs of any kind

Alcoholic beverages

Hard-sided coolers

Brooms, poles and sticks (including selfie sticks)

Beach balls and inflatables

Baseball bats

Banners, Totems or Oversized Signage

Marketing/promotional material for solicitation

Use of laser pointers

Noisemakers, musical instruments, whistles, air horns and boom boxes

Fireworks/firecrackers

Drones or Remote-Control Aircraft, Toys/Cars of any kind or size prohibited

Pets (Except for service animals)

Wrapped packages

Professional photographic tools or equipment (tripods, monopods and lenses longer than 6 inches) unless accompanied by an official Media Credential

Two-Way Radios

Narcotics and Marijuana

Bikes/Hoverboards

Sharpies, markers or paint pens

Tents / sleeping bags

Toy guns or water guns

Kites or sky lanterns

Hula hoops

Instruments



SECURITY DEPLOYMENT

Security Director

Shaw Management	SF Pride	Shaw Amirghassemkhany - 415.720.8741
-----------------	----------	--------------------------------------

Security Company Leads

Company	Location	Contact	Total Shifts	Total Hours
IPS	Gates	John Cris Baloto 714.384.7765	120	1080
MBCS	McAllister / Larkin / Hyde roamers	Mario Baines 510.367.6086	50	450
High Rock	Main Stage / Grove St Stage / McAllister St Stage	Seth Schrenzel 775-229-3075	60	450
VMA	Root of Pride / Leather Alley / Polk / Larkin / Hyde	Vince Mackey 510-381-0815	100	900
AX9	Overnights / BOH	Becca Bliss 408.220.4440	140	1680
SHAW	Road Closures / General Management	Shaw Amirghassemkhany 415.720.8741	50	625
GRAND TOTALS			520	5185



MEDICAL

UCSF - 4 x SF General Emergency Department Physicians + Volunteer RNs

Special Medical Aid - 17 x EMT's Across Celebration Footprint; Walk/Cart Teams

AMR - 2 ALS / 2 BLS for Saturday, June 28, 2025 / 4 ALS / 2 BLS for Sunday, June 29, 2025

BGCA LARKIN HALL - Main Medical

BGCA EXTERIOR - First Aid 1 - Grove and Larkin

FIRST AID 2 - McAllister and Hyde

COMMUNICATIONS

Radio Channels*		
	ZONE 1	ZONE 2
Ch 1	EVENT MANAGEMENT	EVENT MANAGEMENT
Ch 2	TURN OUT	TURN OUT
Ch 3	SITE OPS	SITE OPS
Ch 4	VENDORS / SPONSOR	VENDORS / SPONSOR
Ch 5	MAIN STAGE / ARTIST RELATIONS	CLEANING
Ch 6	COMMUNITY STAGES / ACTIVATIONS	PARADE
Ch 7	RYE	PARADE MGMT
Ch 8	HIGH ROCK SECURITY	HIGH ROCK SECURITY
Ch 9	VMA SECURITY	VMA SECURITY
Ch 10	MBSC	MBSC



Ch 11	SHAW	SHAW
Ch 12	AX9	AX9
CH 13	IPS	IPS
Ch. 14	ROOT of PRIDE	SECURITY MGMT TALK AROUND
Ch 15	MEDICAL	MEDICAL
Ch 16	EMERGENCY	EMERGENCY

Zone 1

Channel 1: Event Management

SF Pride and SILVERBACK will use this channel for overall top level event communications.

Channel 2: Turn Out

Event staff will use this channel to communicate about volunteer matters.

Channel 3: Site Ops

Event staff will use this channel to access Site Ops Dispatch for all site issues.

Channel 4: Vendors/Sponsors/Volunteers

Event staff will use this channel to communicate about vendor, sponsor and matters.

Channel 5: Main Stage / Artist Relations

The Main Stage Manager and Main stage staff will use this channel to communicate. The sound company's employees will be on this channel as well.

Channel 6: Community Stages / Activations

Event staff will use this channel to communicate about the various community stages and activation areas - Leather Alley, Root of Pride and Sundance Saloon/Country.

Channel 7: RYE

The Beverage Manager and members of the F&B Team will use this channel to communicate.

Channel 8: High Rock Security



Channel 9: VMA Security

Channel 10: MBSC Security

Channel 11: Shaw Security

Shaw Management Team will use this channel to communicate across the zone.

Channel 12: AX9

Overnight and BOH Team will use this channel to communicate across the areas that they are covering.

Channel 13: IPS Security

Channel 14: Root of Pride

Channel 15: Medical Dispatch

Event Staff will use this channel to access Medical Dispatch.

Channel 16: Emergency/Security Dispatch

Event Staff will use this channel to access Security Dispatch.

Zone 2

Channel 1: Event Management

SF Pride and SILVERBACK core team will use this channel for overall top level event communications.

Channel 2: Media/PR

Event staff will use this channel to communicate about media and public relations matters.

Channel 3: Site Ops

Event staff will use this channel to access Site Ops Dispatch for all site issues.

Channel 4: Vendors/Sponsors/Volunteers

Event staff will use this channel to communicate about vendor, sponsor and volunteer matters.

Channel 5: Cleaning

Waste Management / greening teams will use this channel to communicate across the venue



Channel 6: Parade

The Parade Manager and members of the Parade Staff Team will use this channel to communicate.

Channel 7: RYE

The Beverage Manager and members of the F&B Team will use this channel to communicate.

Channel 8: High Rock Security

Channel 9: VMA Security

Channel 10: MBSC Security

Channel 11: Shaw Security

Shaw Management Team will use this channel to communicate across the zone.

Channel 12: AX9 Security

Overnight and BOH Team will use this channel to communicate across the areas that they are covering.

Channel 13: IPS Security

Channel 14: Security Management Talk Around

Channel 15: Medical Dispatch

Event Staff will use this channel to access Medical Dispatch.

Channel 16: Emergency/Security Dispatch

Event Staff will use this channel to access Security Dispatch.

****SFPD and Other City Agencies will be provided radios with access to all channels***



Waste Management and Clean Up

Recycling:

San Francisco Pride provides marked disposal cans for recycling, composting, and trash. Marked signs will also be posted. All beverage cups used at our event are 100% recyclable. Additionally, SF Pride has required for several years running that our food exhibitors use and distribute 100% compostable plates, cups, and other materials.

Recycling Plan

We will have recycling locations on site as a part of compounds.

Main Compound: Larkin Street between Hayes and Grove (Wells Fargo Parking Lot)

- 4 x 30 yard trash dumpsters
- 6 x 20 yard recycle dumpsters
- 3 x 14 yard compostable
- 1 x 20 yard mixed debris

We will also have Recycling “mini” stations throughout the site in locations that will not impede the flow of traffic. All Beverage Booths will have 3 stream stations. Diversion reports will be generated by Recology post event.

Event Cleanup Plan

1. DPW: Wells Fargo Parking lot on Grove near Larkin cleaned and deodorized Friday 7 PM.
2. DPW: Post festival cleanup Sunday 9:00 PM. Although the event ends at 6:30PM we will need time to allow the exhibitors and attendees a chance to leave the area.
3. DPW: Steam clean sidewalks where necessary.
4. DPW: Special attention to the street sweeping along the streets of Turk, Polk, Golden Gate and Larkin around the Federal Building.
5. SFP: We will include in the exhibitor packet information, about how each exhibitor must leave their area, defined as their 10" x 10" space, plus 10" in front, in back and to the side if they are a corner space, in broom



clean condition. We will provide them with two trash bags each, more if they request them. The bagged trash will be left on the sidewalk behind their space.

6. SFP: We will maintain the area around Civic Center Plaza during the event with a staff of six on Saturday and twenty on Sunday.

7. SFP: We will do a cleanup on Sunday morning.

8. DPW: Parade Route Cleanup Sunday after the Parade, starting approximately at 2PM.

9. SF Pride provides extra help for DPW with the post event cleanup at Civic Center Plaza, specifically to sweep the accumulated trash into the center of each street for DPW mechanized pickup as well as cleaning Civic Center Plaza.

10. SFP: We will have a team do a final cleanup of Civic Center Plaza on Monday morning after a walkthrough with Rec and Park at 9AM.



**SAN FRANCISCO
PRIDE**



PARADE

2026 San Francisco Pride Parade Route

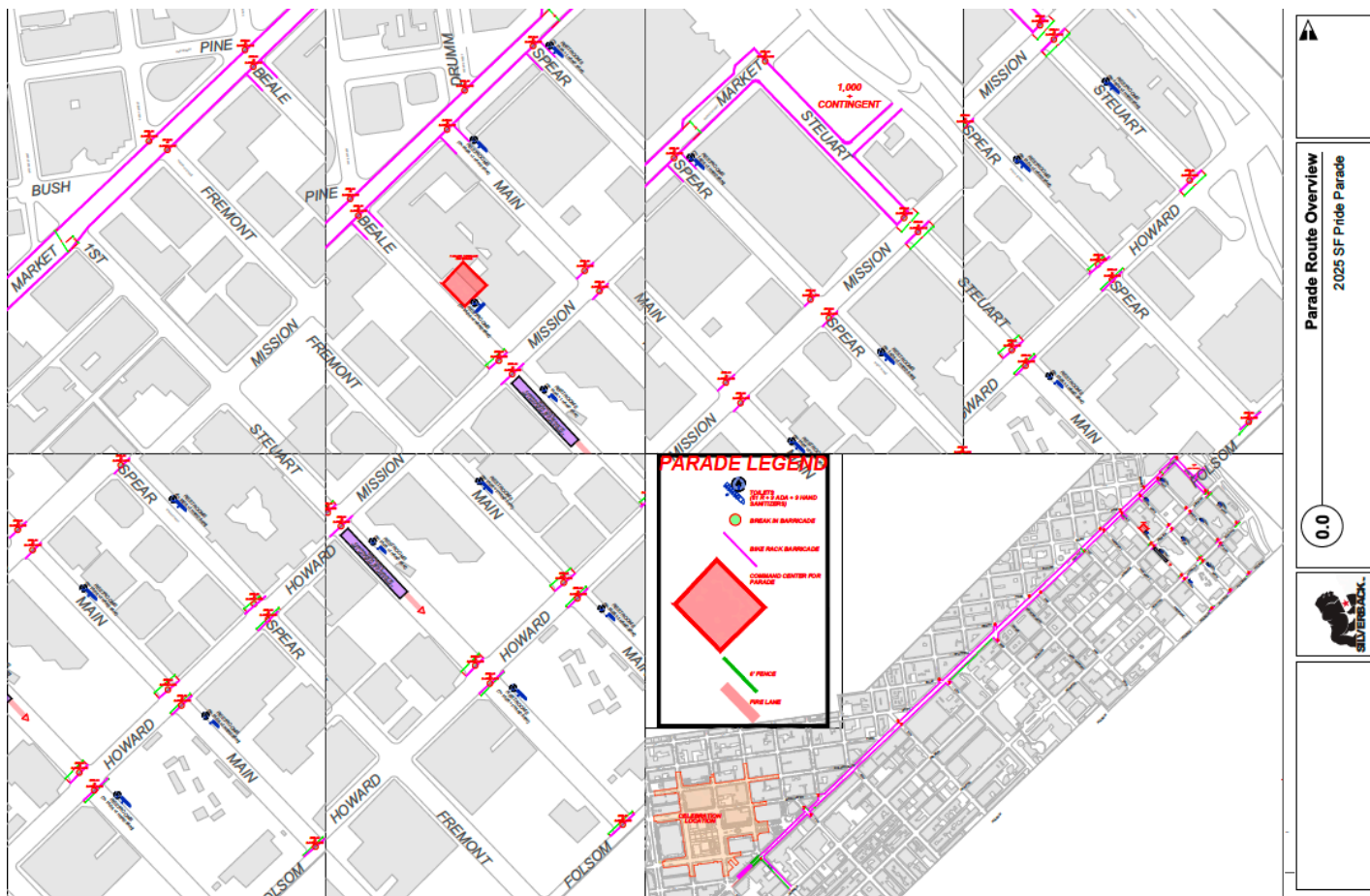

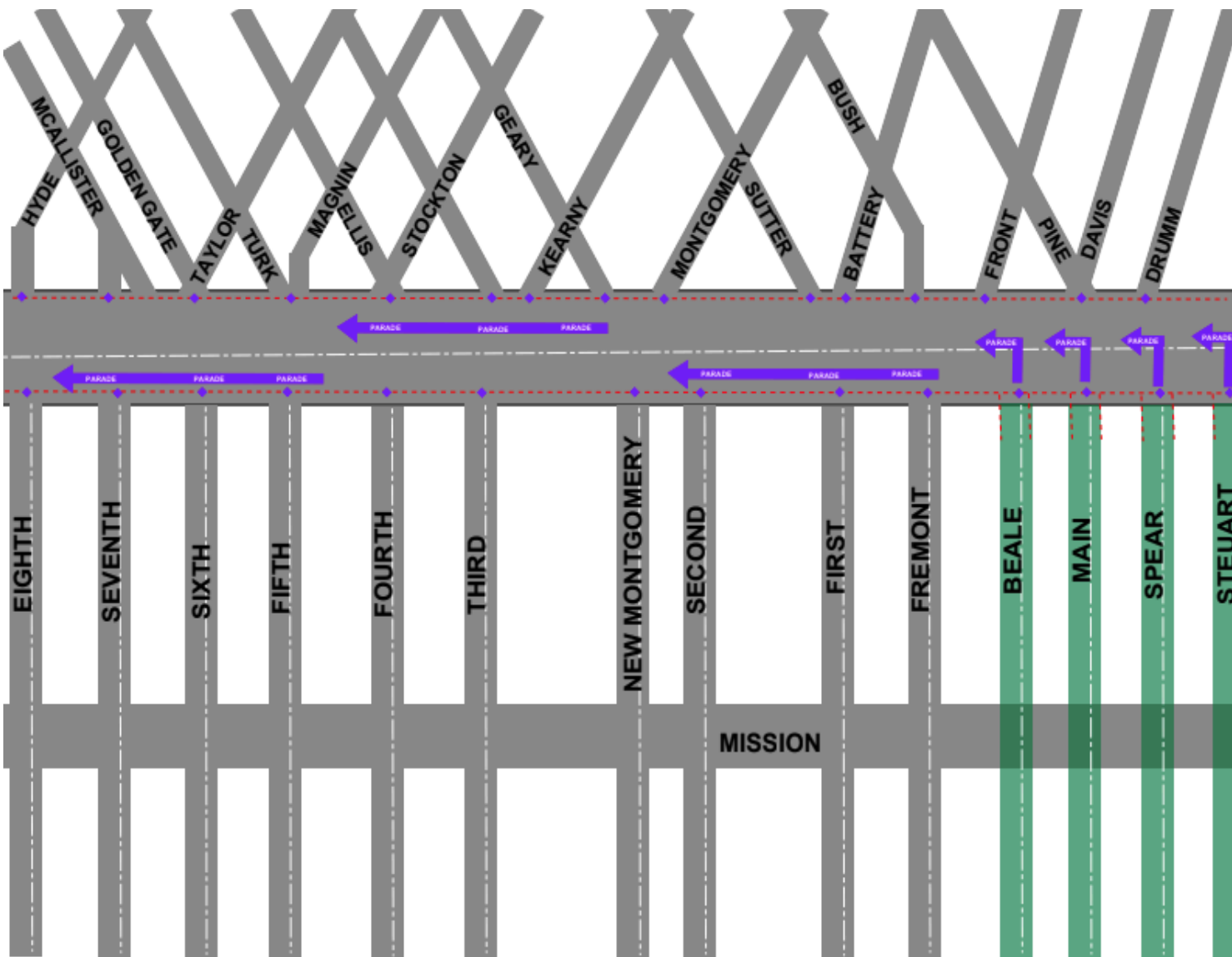

Parade Street Closures

A. Parade Route (Saturday June 27th at 11PM)

- Market Street north side curb lane only from Seventh to Eighth (for grandstand construction) 2. Center taxi lane East/Westbound Market Street between 8th and 9th – for emergency construction.



B. Assembly Area (Sunday June 28th at 6AM)

- Beale from Market to Folsom* (Muni route open to Transbay)
- Market from Beale to Stuart
- Main from Market to Folsom
- Spear from Market to Folsom
- All intersections will remain open in the assembly area
- Stuart closed from Market to End.
- Dykes on Bikes will use Sections A, B, C, D and E. (See Appendix H Assembly area map for details.)

Parade Street Closures

A. Parade Route (Saturday June 27th at 11PM)

- Market Street north side curb lane only from Seventh to Eighth (for grandstand construction) 2. Center taxi lane East/Westbound Market Street between 8th and 9th – for emergency construction.

B. Assembly Area (Sunday June 28th at 6AM)

- Beale from Market to Folsom
- Market from Beale to Stuart
- Main from Market to Folsom
- Spear from Market to Folsom
- All intersections will remain open in the assembly area
- Stuart closed from Market to End.



- Dykes on Bikes will use Sections A, B, C, D and E. (See Appendix H Assembly area map for details.)

C. Parade Route (Sunday, June 28th at 9:00 AM)

- Market from Beale to Ninth (Parade ends at 8th and Market)

D. Parade Dispersal (Sunday, June 28th at 9:00 AM)

- Eighth from Market to Howard

E. Broadcast Street Closures Temporary ABC Street Closure (Sunday, June 28th 12:01 AM - Sunday, June 28th 5 PM)

- Sutter St between Market and Sansome Sts
- Sansome St (N Bound) between Sutter and Bush St

Parade Assembly Area Closures

1. Market from Steuart to First
2. Steuart St. to Howard St.
3. Spear St. to Folsom
4. Main to Folsom
5. Beale to Folsom

Barricades will be dropped at the corner of the North West intersections per block.

1. Steuart & Market, Mission, Howard
2. Spear & Market, Mission, Howard, Folsom
3. Main & Market, Mission, Howard, Folsom
4. Beale & Market, Mission, Howard, Folsom
5. Don Chee Hardscape (Command Center)
6. Parade team link the barricades in the assembly area
7. Barricades should be dropped by 4am Sunday, June 25th.
8. Will need traffic control at each intersection.
9. Intersections will remain open to through traffic
10. Traffic Control is needed at each intersection
11. Barricades should be in place by 4 am.

- 12. Line-up/Assembly begins at 6:30 am
- 13. The parade starts at 10:30 am

Assembly Area – PARADE ASSEMBLY AREA CLOSURES BEGIN @ 6 AM



Dispersal

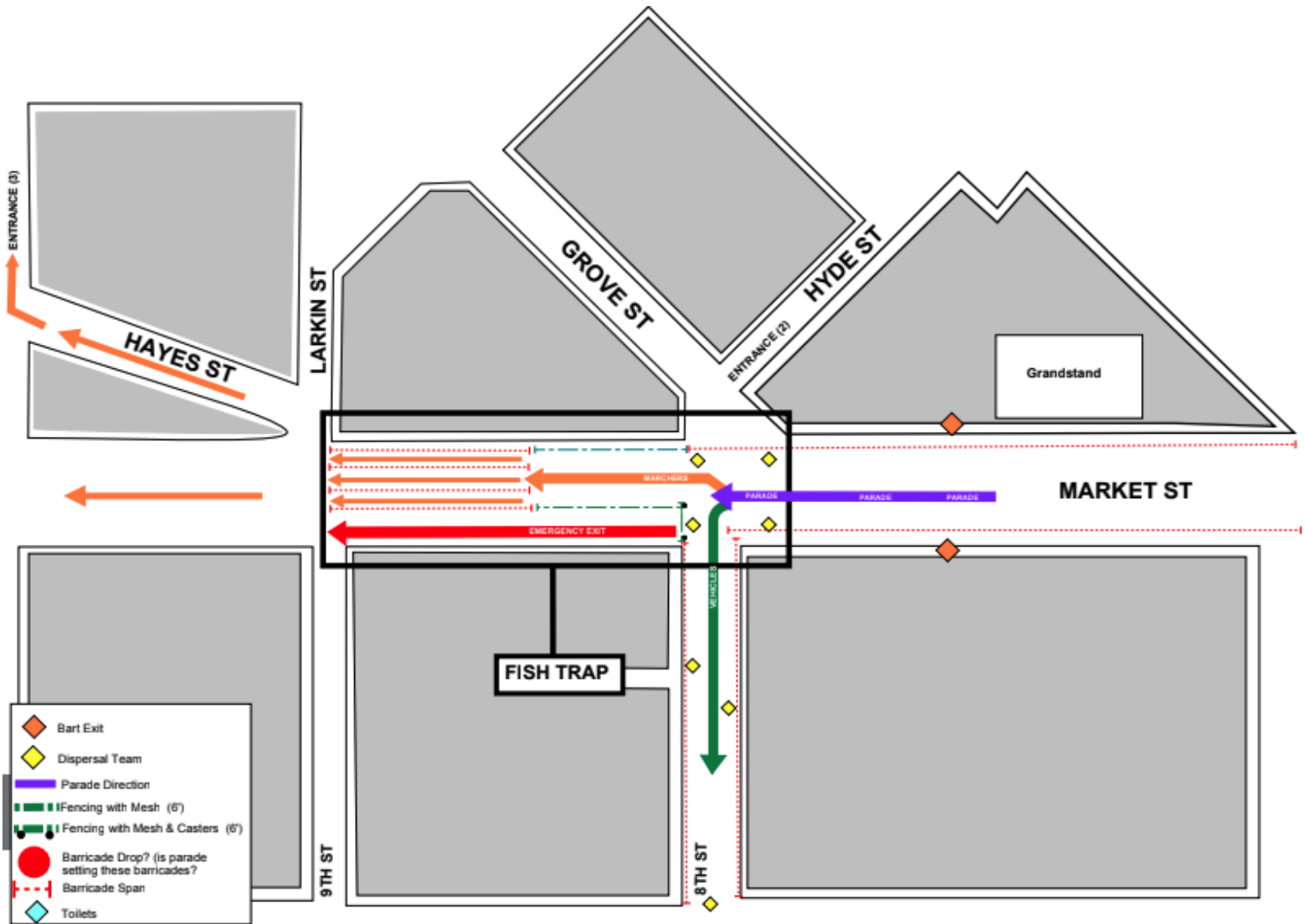

DISPERSAL CLOSURE 8th STREET FROM MARKET TO MISSION @ 9 AM

• Market between 8th and 9th

1. (3) lanes of barricade on Market between 8th and 9th
2. (2) lanes of 6' mesh fencing
3. (1) swing gate 6' fencing with mesh on casters

• 8th between Market and Mission

1. Street Closure on 8th between Market and Mission
2. Barricade to run the entire length of 8th between Market and Mission



PARADE CONTINGENTS

***order to be confirmed**

American Red Cross
AppsFlyer
Asexuality SF
Assemblymember Catherine Stefani
Assemblymember Matt Haney
Australia and New Zealand
Azza Beanz
BAAITS - Bay Area American Indian Two-Spirits
Bamba
Bare Chest Calendar
Bawdy Caste Rocky Horror
Bay Area Directors of Admission (BADA)
Bay Area Medical Academy
BeefySchofield
Berkeley Lab Lambda Alliance
Brady San Francisco
Brice Yent
Build Out Alliance
California Psychological Association
California Working Families Party
Cheer San Francisco
City College of San Francisco
Clear Channel Outdoor
Consulate General of Canada in San Francisco/ Silicon Valley
Cookie's Crew
Dance With Pride - Rhythm & Motion and Dancers' Group
David Chiu - San Francisco City Attorney
Desi Rainbow
District 5 Supervisor Bilal Mahmood
Dolores Flow



Doula Care Association
DPR Construction
eBay United in Pride Community of Inclusion
Electrical Workers Minority Caucus
EnterPRIDE
Everyone Loves a Corgi
Folclórico Colibri
Free Mom Hugs
GaysforTrump
Girl Scouts of Northern California
GLBTQ+ Asian Pacific Alliance (GAPA)
GLIDE PRIDE TEAM
Grand Ducal Court of SF
Health Right 360
Heavy Petting Zoo CommUnity Party Car (HPZ Events 501c3)
Horizons Foundation
Imani Rupert-Gordon w/NCLR
Imperial Council of San Francisco, Inc
International Interior Design Association (IIDA) - Northern California Chapter
Jalisco is Mexico - Guadalajara and Puerto Vallarta Tourism Board
JCRC Bay Area (Proud & Jewish)
Joan
Joaquín Torres, Assessor-Recorder of San Francisco
Kendo Brands
Kilpatrick Townsend & Stockton LLP
Kim McCann
Latino Wellness Center
Leoniel Enopia
LOVB San Francisco Volleyball
Macy's
MamaDora & Esforço
Mission Action
MISTR



Museums with Pride
Muttsville Senior Dog Rescue
Myah Kuenzi
NAMI San Francisco
Nine Lives
Noes Nest Bed And Breakfast
NorCal Furrries
North Coast States Carpenters Union
Okta - Pride ERG
Openhouse
Our Family Coalition
Pacific Primary
Parker Institute for Cancer Immunotherapy
Pauly The Gay
PFLAG
Planned Parenthood Northern California
PlayStation
Project Open Hand
Prometheus Real Estate Group
Psychological Association for Gender Expression and Sexuality (PAGES)
Queer Deadheads
Reckless Joy & Radical Action
Righteously Outrageous Twirling Corps
Sack Capital Partners
SAG-AFTRA San Francisco-Northern California Local
Sammie Dawson
San Francisco Community Health Center & TRANS THRIVE
San Francisco Fire
San Francisco Gay Men's Chorus
San Francisco Health Plan
San Francisco Health Plan
San Francisco Human Services Agency
San Francisco Opera Association



San Francisco Police Officers Pride Alliance
San Francisco Public Library
San Francisco Public Works
San Francisco Sheriff's Office
San Francisco Unified School District
San Francisco Zoo
San Francisco Pride Band
San Mateo County Transit District (Caltrain/SamTrans)
Scouts for Equality - Golden Gate
Senator Scott Wiener
Seneca
Sephora
Septerna
SF Brownie Mary Democratic Club
SF Earthquakes LGBTQ+ Hockey
SF Leather Pride and Kink Contingent
SF Public Health
SF Treasurer Cisneros
Soul of Pride
Southeast Asian Community Center
Stanford Medicine
Stanford Pride
Steamworks Baths
Stonewall Sports - SF
Supervisor Matt Dorsey
Taiwan in SF
Taiwanese Americans for Equality
The John Stewart Company
The Rotary Clubs of San Mateo, San Francisco, and Marin Counties
The San Francisco District Attorney's Office and District Attorney Brooke Jenkins
The Sisters of Perpetual Indulgence, Inc.
The Walt Disney Company
Tiffany & Co.



Truong Phan
UCSF Alliance Health Project and Ward 86
UFCW Local 5
United Airlines
United in Spirit
United Proud Women
United States Senator Alex Padilla
University of California Berkeley
University of California, Merced
University of San Francisco Pride
University of the Pacific
UTOPIASF United territories of Pacific Islanders alliance
Vets in Vans
Western Roundup Living Sober
Whole Foods Market
Williams Sonoma Inc.
Zoox

2026 GRAND MARSHALLS

Roger Doughty
Lifetime Achievement Grand
Marshal

Imani Rupert-Gordon
Members' Choice

John Weber
Board Choice

Ms. Bob Davis
Board Choice

Marcel Pardo Ariza
Public Choice

TRANS:THRIVE
Organizational